

# TEAMBOX

F1-180-V2

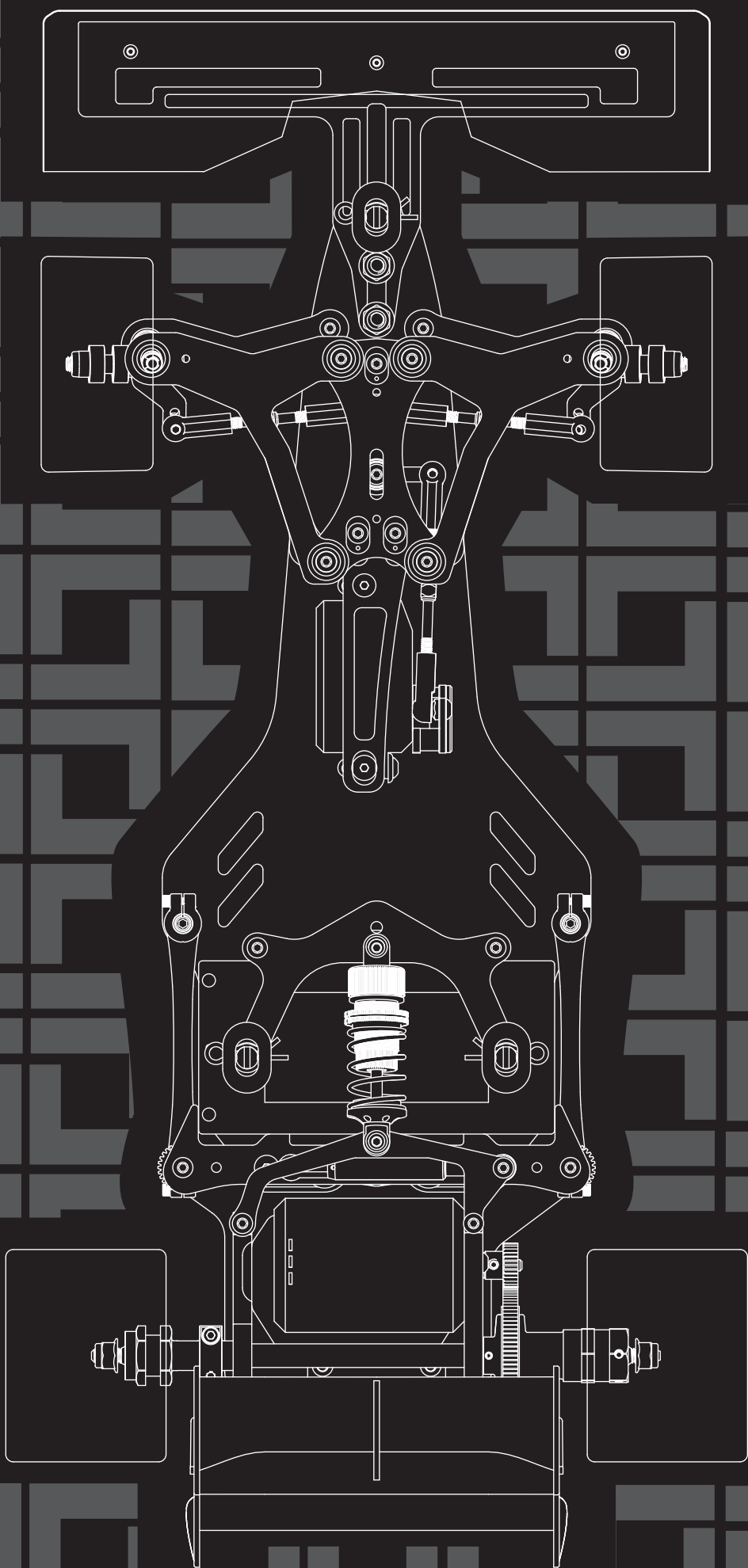

Thank you for purchasing this TEAMSAXO product. This high performance competition kit has been proudly manufactured by TEAMSAXO World Champion R/C car manufacturer.  
Proper assembly of this product will provide fun,safe enjoyment.

## PRECAUTIONS FOR SAFE ENJOYMENT OF YOUR R/C CAR

For children under the age of 13, parental guidance is recommended when running.

### ASSEMBLY PRECAUTIONS

Do not assemble around small children. The parts can be dangerous if accidentally swallowed.

Check the contents carefully before assembly. Please contact Customer Support if you happen to notice any defective or missing items.

You will find the assembly process much easier by carefully reading through the manual, and familiarizing yourself with the instructions.

Many different tools are required during assembly. For safety purposes, please use suitable tools. Exercise extra caution when using a sharp tool such as a hobby knife.

Many different materials are used for the parts. Use extra care when handling parts with sharp edges, such as machined metal parts.

When cutting plastic parts, watch for any flying parts.

Try to assemble any rotating parts of drivetrain parts as smooth as possible.

Bundle wires neatly away from the ground or any moving drivetrain components. Make sure that all wires are properly connected to prevent shorting.

Unnecessary modifications may be unsafe and hinder performance.

Always paint in a well ventilated area away from flames.

### PRECAUTIONS BEFORE RUNNING

Teamsaxo R/C cars are built for competition use, and some models may exceed speeds of 40km per hour. Practice common sense and run the car in open safe places, or R/C car tracks.

Do not run the car on public roads with high amounts of traffic, or in areas that may cause an inconvenience to people in that area.

R/C cars are controlled using radio frequency. In a worst-case scenario, radio interferences may cause loss of control.

If others near you are running R/C cars, confirm that they are not running on the same frequency.

R/C cars do not like water. Avoid running on rainy days, or areas with water puddles. Exposure of the electronics to water may cause loss of control or damage to the electronics.

The drivetrain of an R/C car consists of many moving parts like gears, belts, shafts, and tires. Avoid touching these areas when the battery is connected.

Many parts of an R/C car will become hot after running. Allow the parts to sufficiently cool before conducting any maintenance.

### BEGINNING A RUN

1. Place the R/C car on a stand so the wheels are off the ground.
2. Confirm that the speed controller switch is OFF, and connect the motor and battery
3. Extend the transmitter antenna and turn the switch ON. (It is unsafe to use a transmitter with low voltage. Make sure that the transmitter batteries are good before running)
4. Turn the speed controller switch ON.

### FINISHING A RUN

1. Turn the speed controller switch OFF.
2. Disconnect the battery.
3. Turn the transmitter switch OFF, and retract the antenna.

## ASSEMBLING TOOLS REQUIRED (NOT INCLUDED IN KIT)

### Scissors

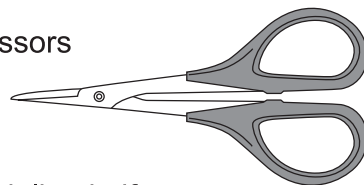

### Modeling knife



### Side cutters

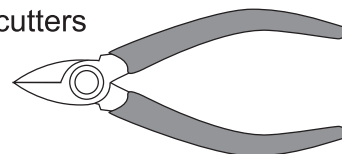

### Long nose pliers

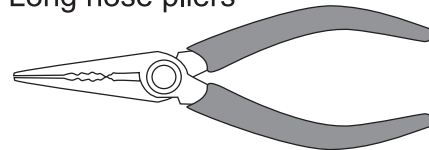

### Hex wrench (1.5mm)

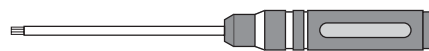

### Hex wrench (2mm)

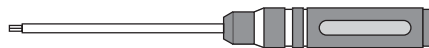

### Tweezers



## F1-180-V3 CHASSIS SPECIFICATION

Overall Length	: 420mm	Overall Width Front width	: 185mm
Wheelbase length	: 266mm	Rear width	: 199mm
Weigh Chassis only	: 380g		

### Cap

	M3X4	SJG304
	M3X6	SJG306
	M3X8	SJG308
	M3X10	SJG310
	M4X18	SJG418

### Cap screw

	M2X6	SG206
	M2.5X6	SG2.56

### Grub screw

	M3X3	SK303
	M3X10	SK310

### Screw

	M2.5X4	SIG2.54
	M3X6	SIG306
	M3X8	SIG308
	M3X10	SIG310
	M3X16	SIG316

### Lock nut

	M3	SN-M3
	M3	SN-M3-F
	M4	SN-M4
	M4	SN-M4-F

### Ball bearing

	5X8X2.5	MR085-OR
	5X10X4	MR105-OR
	6.35X9.525X3.175	FR168ZZ
	6.35X9.525X3.175	R168-2RS
	3X8X3.5	F3-8M

### E-Ring

	E-Ring 2.0	OE-E2.0
--	------------	---------



① ~ ③  
Kit Bag A



TS0104109.....6



TS0204004.....6

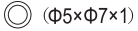

TS0105006.....6

## 1 Upper arms

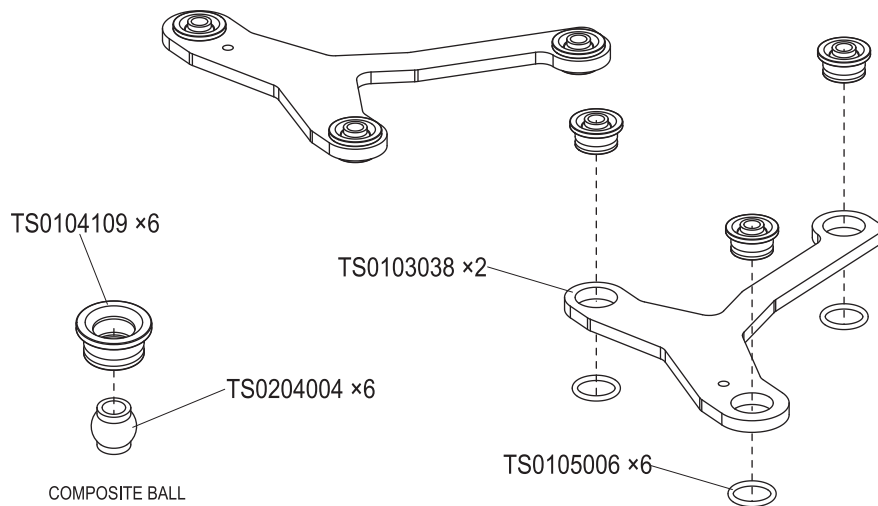
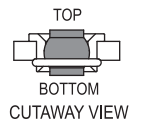

TS0104109.....2



TS0204004.....2

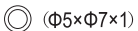

TS0105006.....2



TS0102032.....2



SN\_M3.....2

## 2 Lower arms

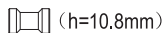
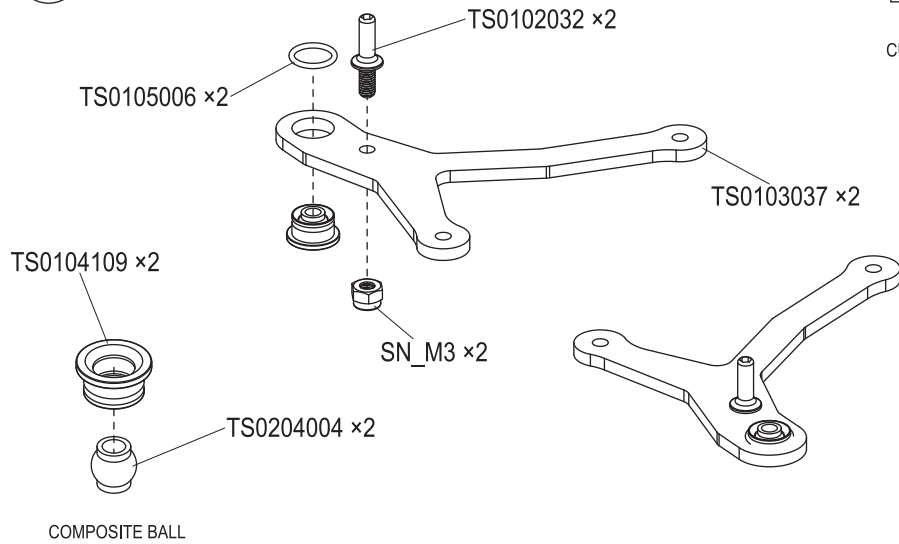
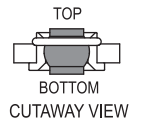

TS0101052.....4

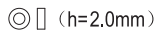

TS0101054.....4



SJG\_M3X8.....4



SIG\_M3X6.....4

## 3

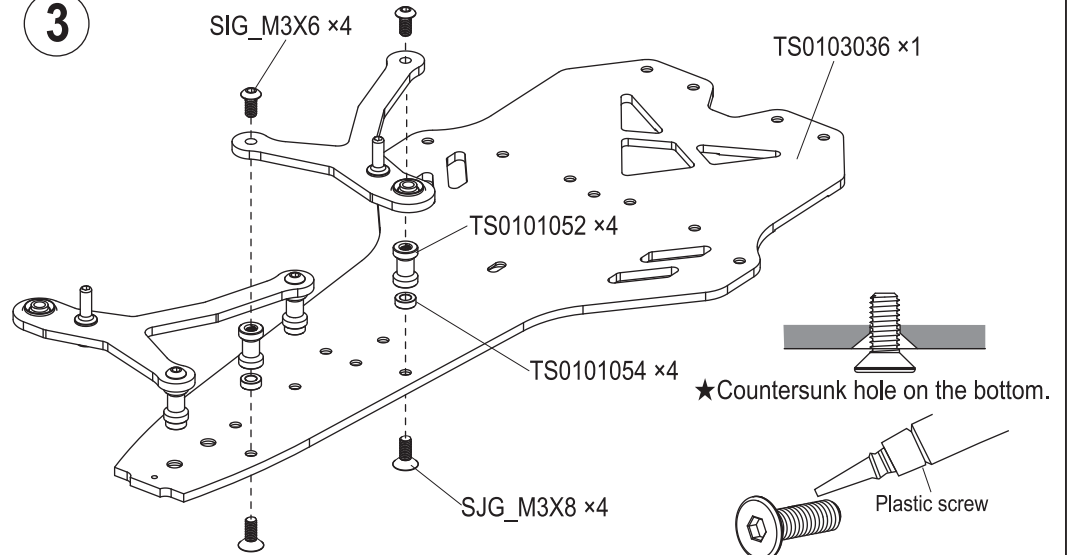

Apply thread lock to the sections shown by this mark.



## 4 ~ 5 Kit Bag B



TS0101007.....3

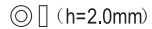

(h=2.0mm)

TS0101054.....1

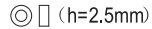

(h=2.5mm)

TS0101029.....4

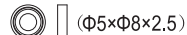

(Φ5×Φ8×2.5)

MR085-OR.....2



SIG\_M3X6.....1



SIG\_M3X10.....3

### 4

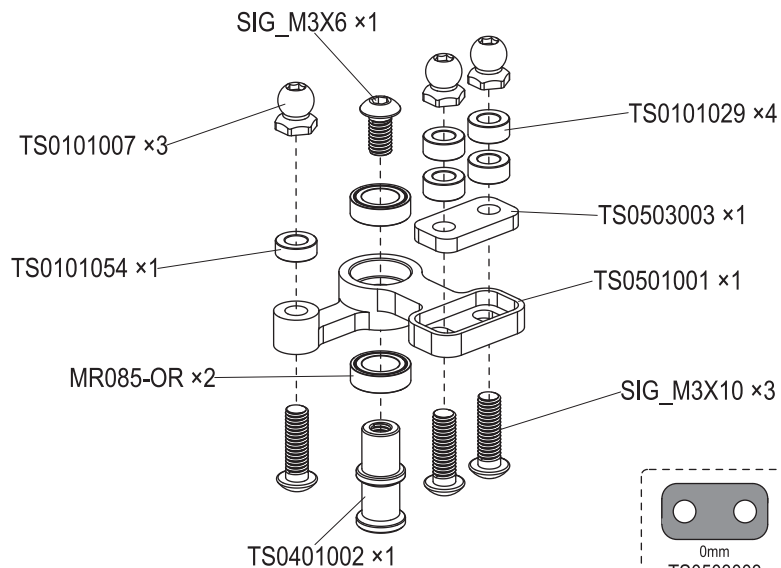

### 5



SJG\_M3X6 .....1

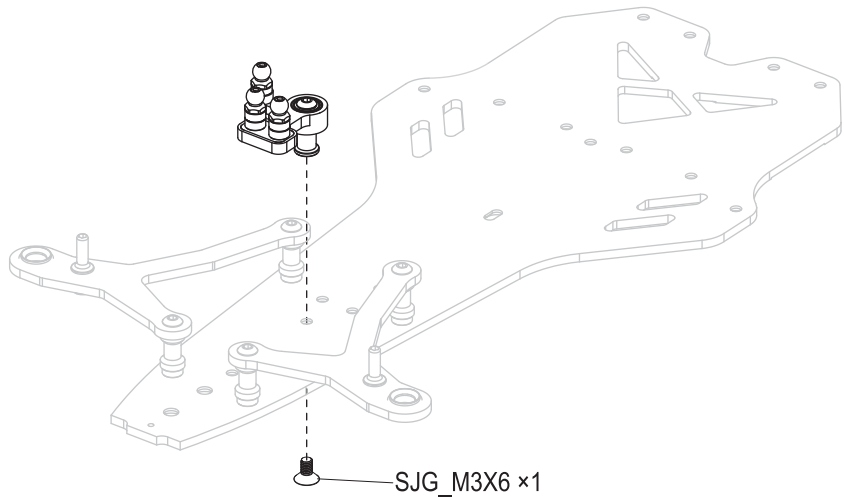

## 6 ~ 10 Kit Bag C



(h=21mm)

TS0101053.....1



SJG\_M3X6.....1



SIG\_M3X6.....2



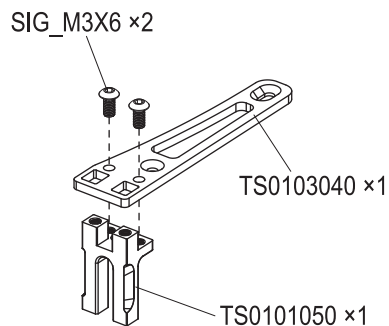

### 6 Alternative 1

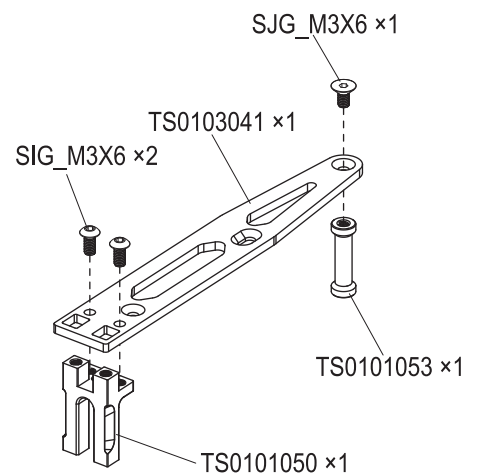

### Alternative 2

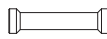



-  (h=26,5mm)  
TS0101051.....1
-  (CASTER 6°, 9°)  
TS0101055.....3
-  (CASTER 3°, 12°)  
TS0101056.....3
-  SJG\_M3X6.....4
-  SIG\_M3X10.....3

## 7 Alternative 1

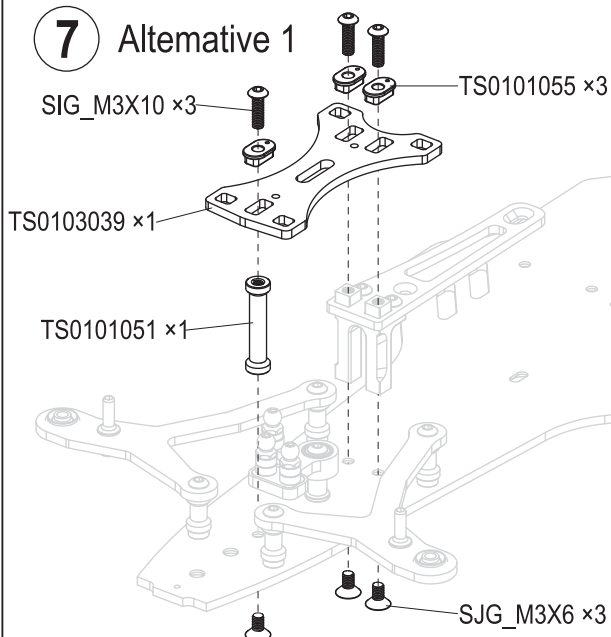

### IMPORTANT!

All three bushings MUST have same orientation.  
These bushings adjust the front CASTER:

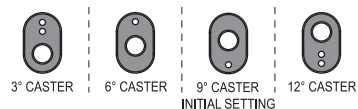
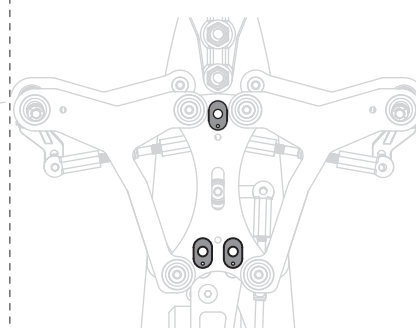

These eccentric bushings adjust the front CASTER.  
MORE caster angle = better cornering speed, increased traction rolling.  
Use on large, open tracks where cornering speed is needed.  
LESS caster angle = more reactive steering. Use on technical tracks where a lot of steering response is needed.

OP

## Alternative 2

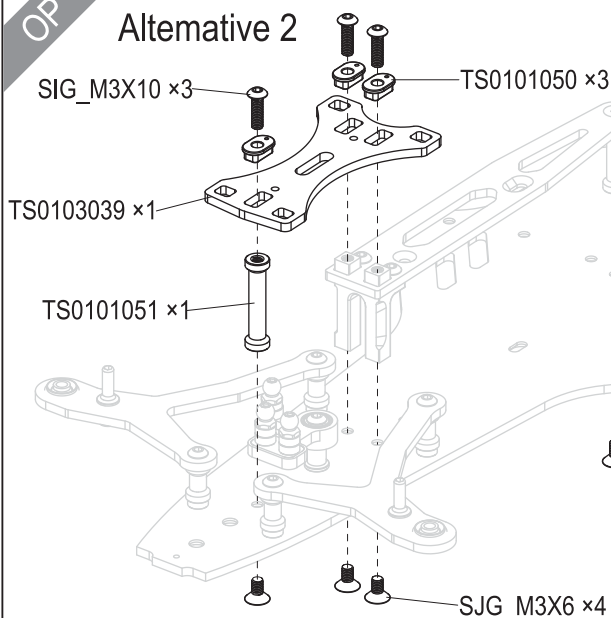



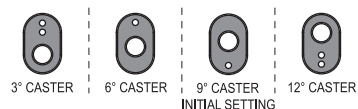
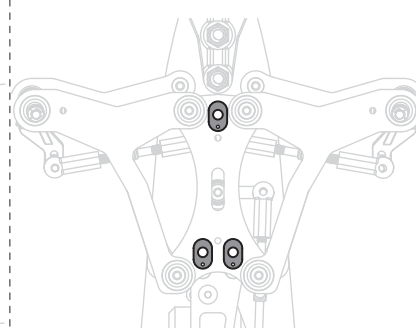

### IMPORTANT!

All three bushings MUST have same orientation.  
These bushings adjust the front CASTER:



These eccentric bushings adjust the front CASTER.  
MORE caster angle = better cornering speed, increased traction rolling.  
Use on large, open tracks where cornering speed is needed.  
LESS caster angle = more reactive steering. Use on technical tracks where a lot of steering response is needed.

-  (CAMBER 1.5°, 2.0°)  
TS0101057.....4
-  (CAMBER 1.0°, 2.5°)  
TS0101058.....4
-  | (Φ3×Φ6×0.3)  
TS0102033.....4
-  SIG\_M3X10.....4

## 8

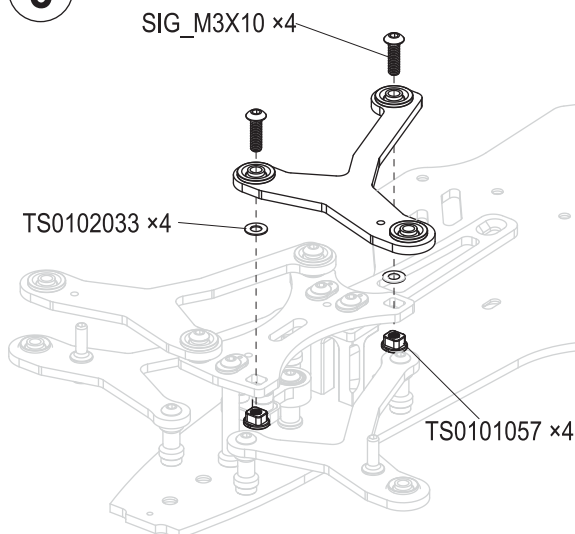

### IMPORTANT!

All four bushings MUST have same orientation.  
These bushings adjust the front CAMBER:

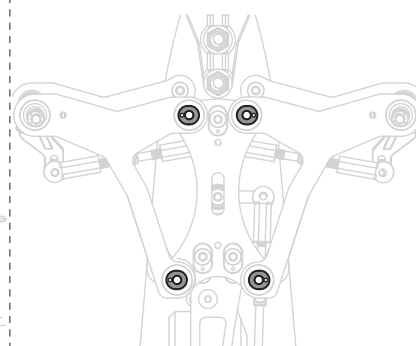

These eccentric bushings adjust the front CAMBER.  
The more camber angle, the more steering there is. However, it makes the car more sensitive and more difficult to drive.  
Use LESS camber angle for carpet and other high-traction tracks.  
Use MORE camber on asphalt and low-traction tracks.



TS0101007.....2



TS0102015.....2



TS0104023.....2



SIG\_M2.5X4.....2



SIG\_M3X8 .....2

9

## Attaching front uprights

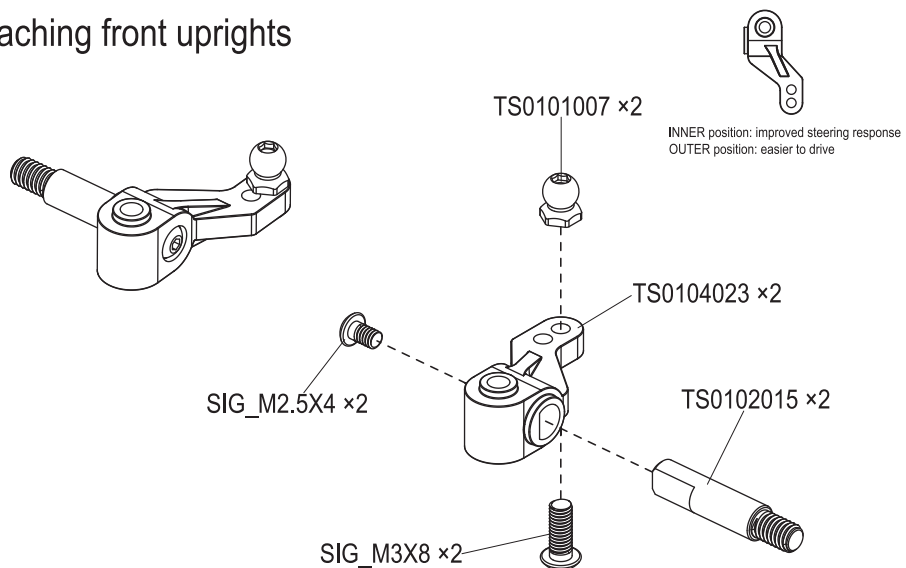

 (L=33.6mm)

TS0102013.....2



TS0101030.....2

 (h=0.5mm)

TS0101026.....6

 (h=2.0mm)

TS0101054.....2



TS0102003.....2



OE\_E2.0.....4

10

## FRONT COIL SPRINGS



TS0102805	C=0.4-GOLD(SOFT)	OPTION
TS0102003	C=0.4-SILVER(MEDIUM)	INCLUDED
TS0102806	C=0.4-BLACK(HARD)	OPTION

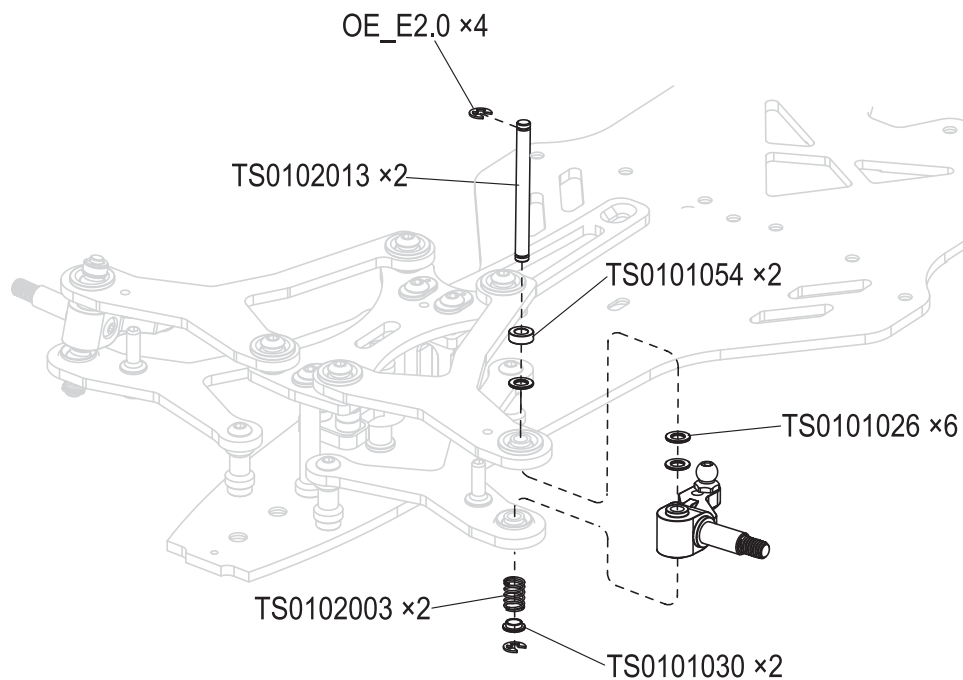



⑪  
Kit Bag D

 SJG\_M3X8.....5

⑪ Attaching motor mount

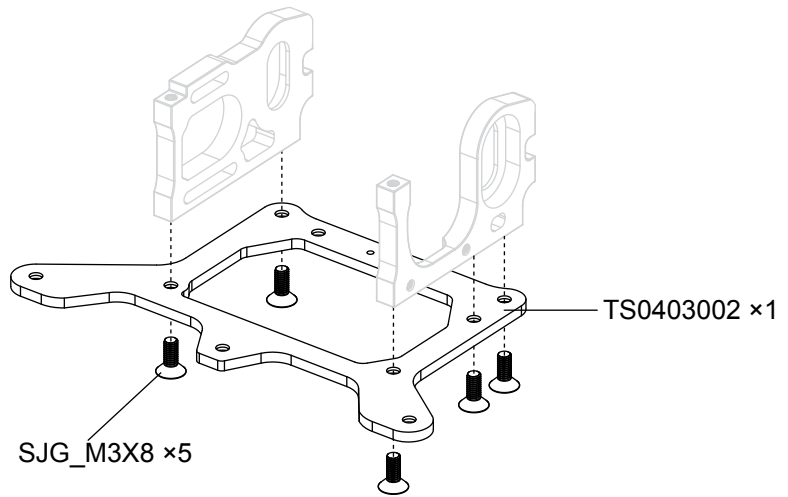



⑫ ~ ⑲  
Kit Bag E

 TS0102010.....1  
 SG\_M2X6 .....2

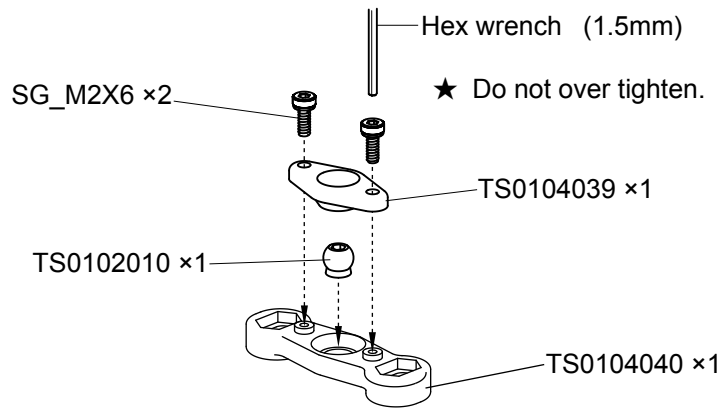

⑫ Lower brace

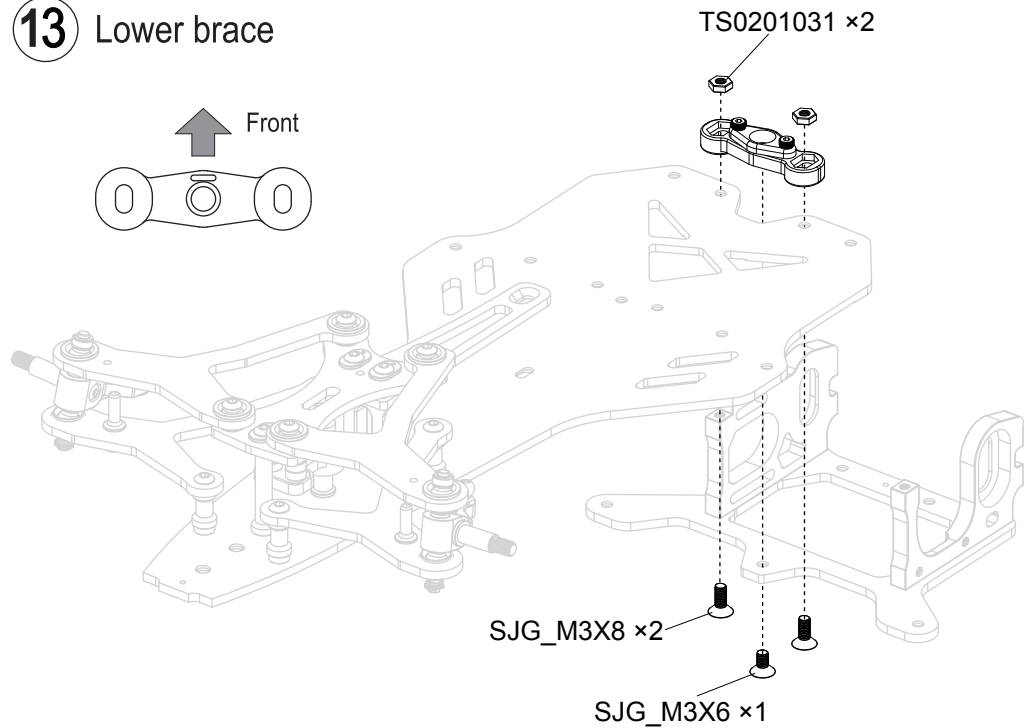

 (h=2.0mm)  
TS0201031.....2  
 SJG\_M3X6.....1  
 SJG\_M3X8.....2

⑬ Lower brace



 TS0102010.....4  
 SG\_M2X6.....4

## 14 Attaching lower brace



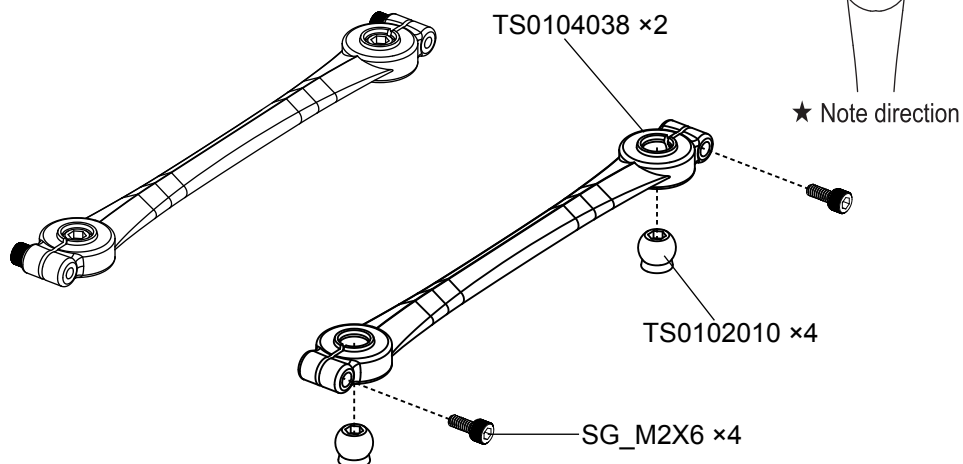

★ Do not over tighten.

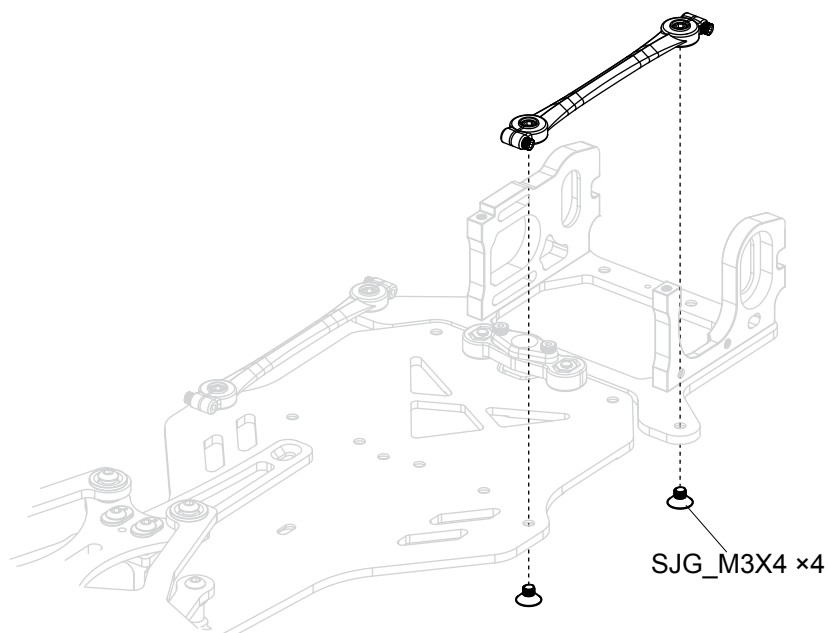

 SJG\_M3X4 .....4

## 15



 TS0101007.....1  
  
 TS0102001.....2  
 TS0104042.....2  
 SIG\_M3X6 .....1  
 SIG\_M3X10.....2

## 16 Alternative 1

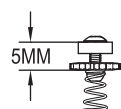
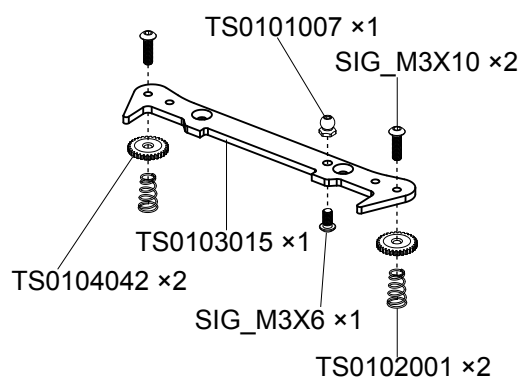

★ Attach as shown.

SIDE SPRINGS		
TS0102811	C=0.5-BLUE(SUPER)	OPTION
TS0102810	C=0.5-GREEN(SOFT)	OPTION
TS0102809	C=0.5-WHITE(MEDIUM)	OPTION
TS0102801	C=0.6-GOLD(HARD)	OPTION
TS0102001	C=0.6-SILVER(HARDER)	INCLUDED
TS0102802	C=0.6-BLACK(HARDEST)	OPTION

## Alternative 2

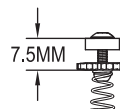
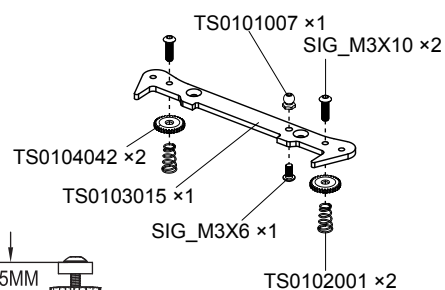

★ Attach as shown.

 (h=16mm)

TS0401005.....2



SJG\_M3X6 .....4

17

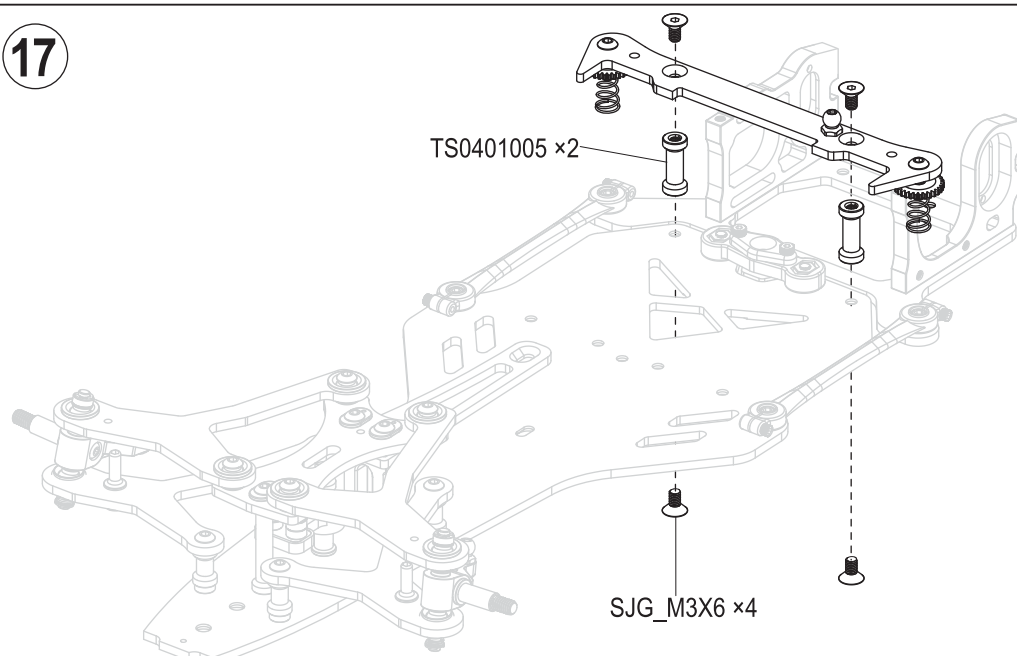

TS0401005 ×2

SJG\_M3X6 ×4



TS0101007.....2

 (h=2.5mm)

TS0101029.....1



SJG\_M3X8 .....1



SIG\_M3X6 .....1



TS0104026.....2



SK\_M3X10 .....1

18

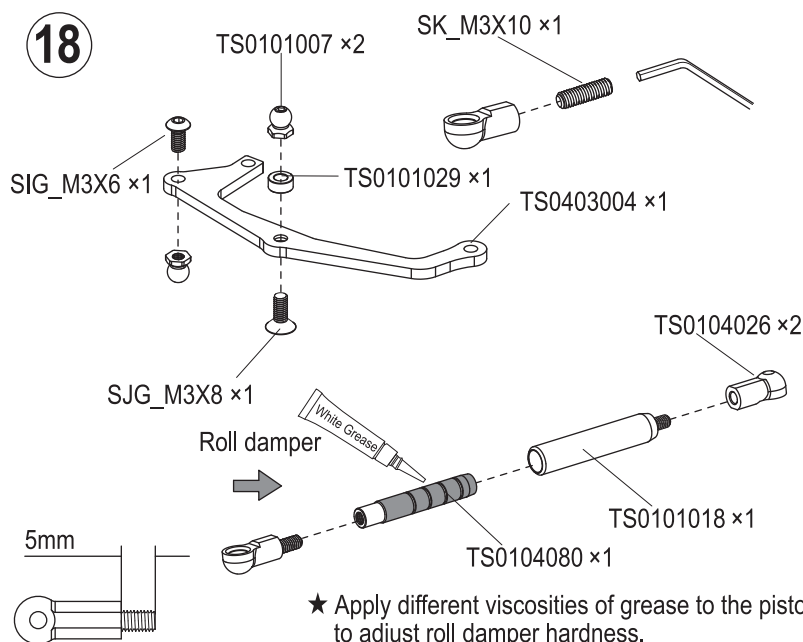

TS0101007 ×2

SK\_M3X10 ×1

SIG\_M3X6 ×1

TS0101029 ×1

TS0403004 ×1

SJG\_M3X8 ×1

Roll damper

TS0104026 ×2

TS0101018 ×1

TS0104080 ×1

★ Apply different viscosities of grease to the piston to adjust roll damper hardness.

#### VPPRO OILS

RS-304-1K	1000cSt
RS-304-2K	2000cSt
RS-304-3K	3000cSt
RS-304-4K	4000cSt
RS-304-5K	5000cSt
RS-304-6K	6000cSt
RS-304-7K	7000cSt
RS-304-8K	8000cSt
RS-304-10K	10000cSt
RS-304-12.5K	12500cSt
RS-304-15K	15000cSt
RS-304-20K	20000cSt
RS-304-30K	30000cSt
RS-304-40K	40000cSt
RS-304-50K	50000cSt



SIG\_M3X6.....2

19

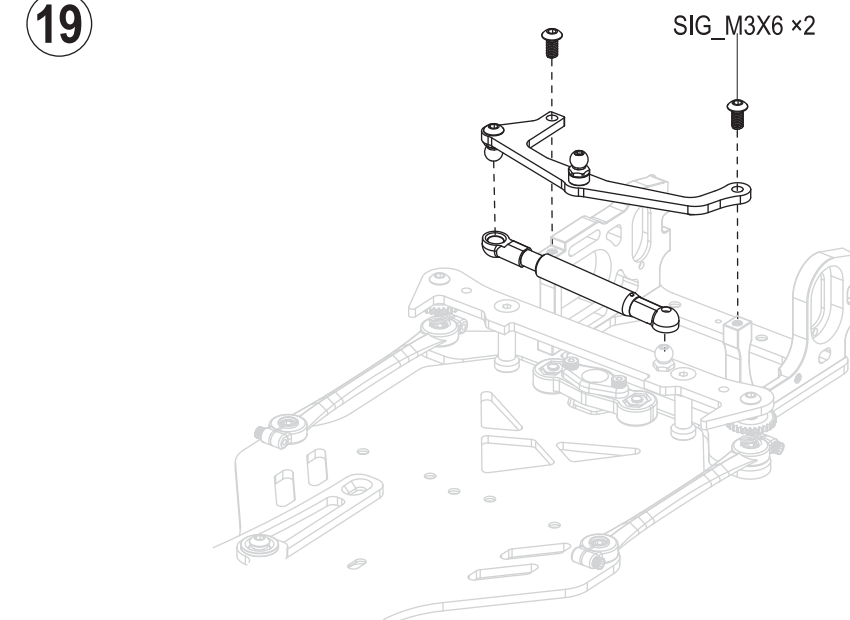

SIG\_M3X6 ×2



20 ~ 22  
Kit Bag F

- TS01023.....1  
 (Ø6.35)  
 TS0101002.....1  
 (Ø6.35×Ø9.525×3.175)  
 R168-2RS.....1  
 (Ø6.35×Ø9.525×3.175)  
 SG\_M2.5X6.....2

## 20 Attaching rear shaft



★ These eccentric bushings adjust the RIDE HEIGHT of the rear pod.  
Make sure to use the SAME eccentric bushings on BOTH sides.

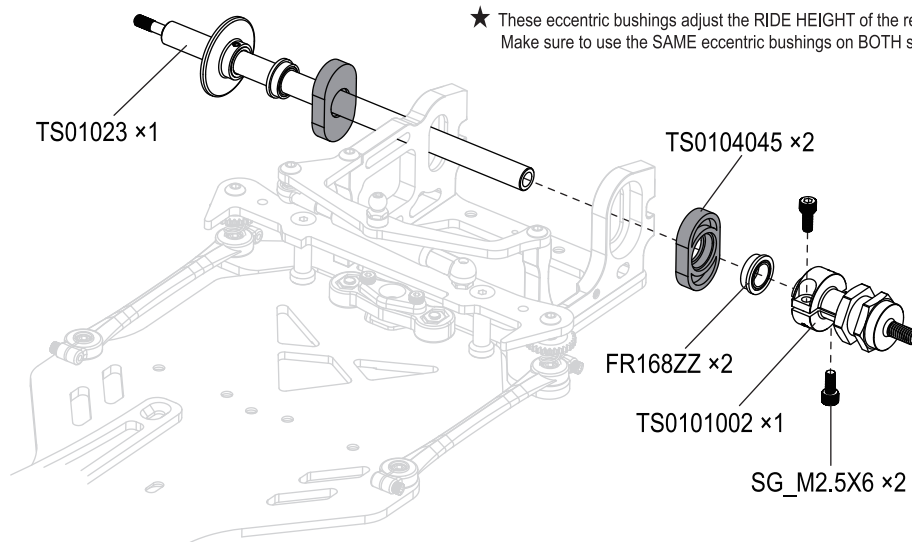

- TS0501021.....1  
 (Ø6.35×Ø9.525×3.175)  
 TS0102004.....2  
 (Ø6.35×Ø9.525×3.175)  
 R168-2RS.....1  
 (Ø6.35×Ø9.525×3.175)  
 FR168ZZ.....2  
 (Ø6.35×Ø9.525×3.175)  
 TS0102034.....2  
 (Ø6.35×Ø9.525×3.175)  
 SN\_M3-F.....1

## 21 Ball differential

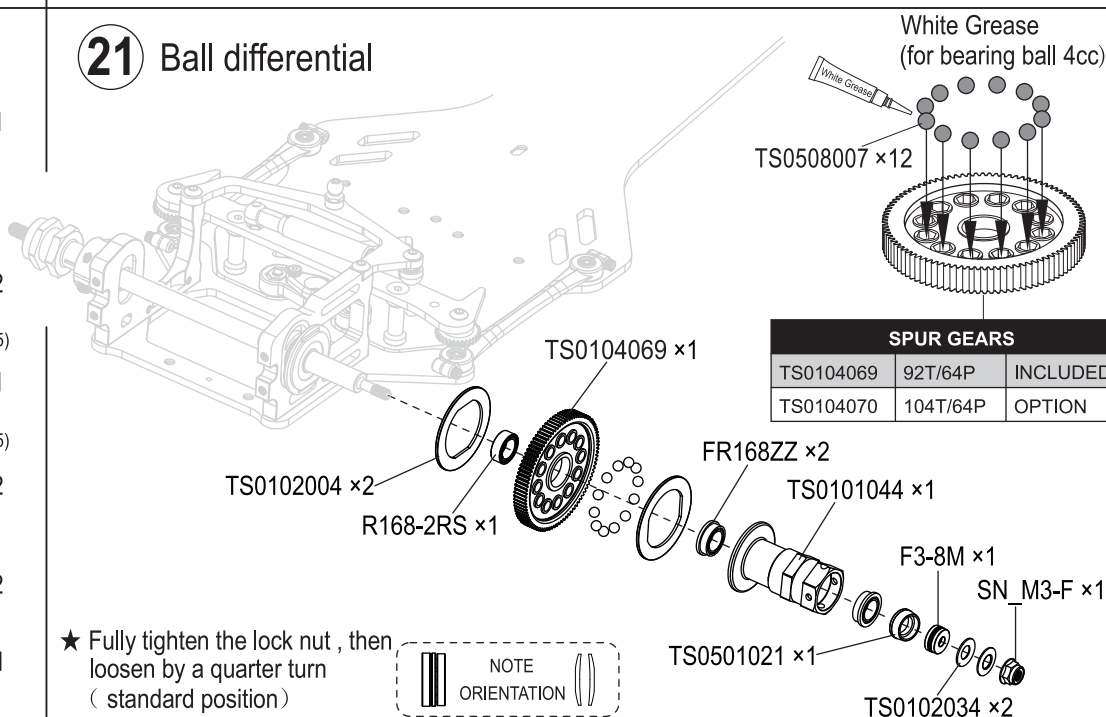

## 22 Attaching diff cap

- TS0101005.....1  
 (Ø2×14)  
 TS0102028.....1  
 (Ø2×14)  
 SK\_M3X3.....1

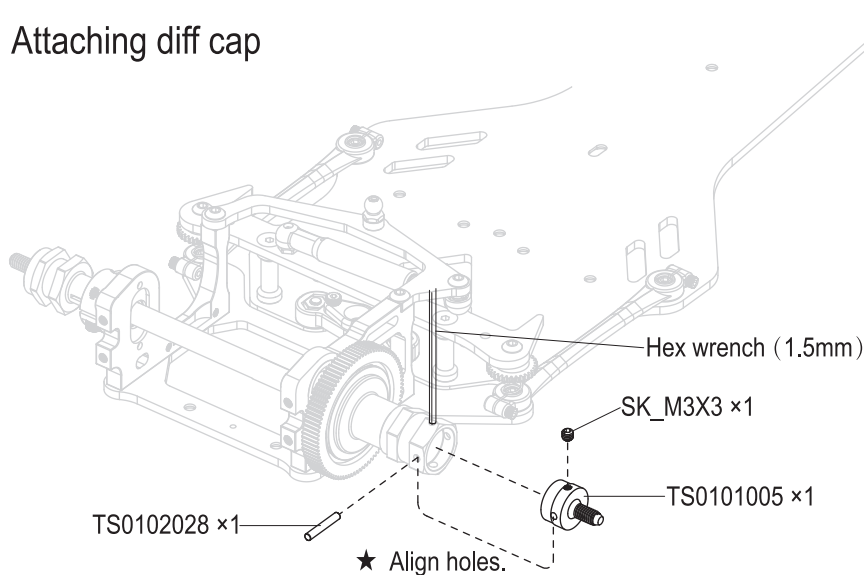





23 ~ 25  
Kit Bag G



TS0201007.....1



SJG\_M3X4.....2

## 23 Alternative 1

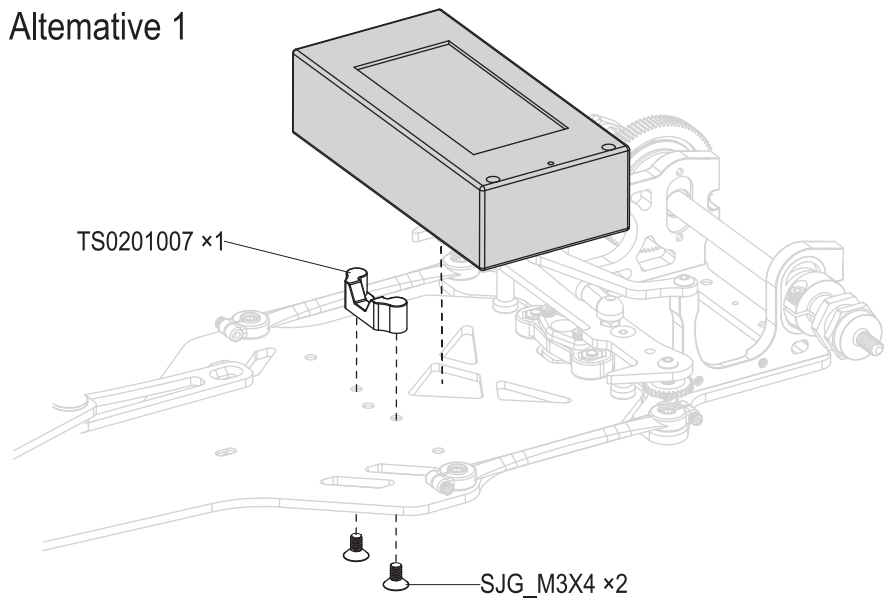

OP

## Alternative 2

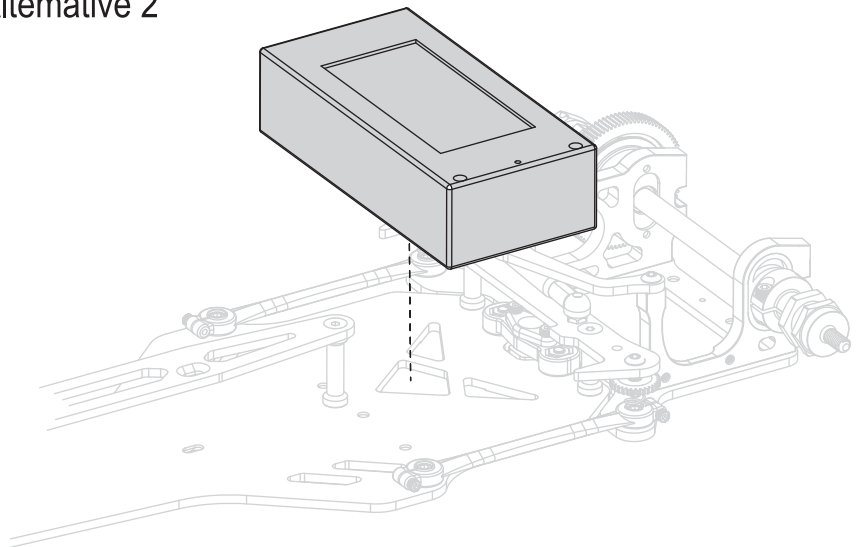

TS0104005.....2



TS0101007.....1



TS0104003.....2



TS-P034 (R6).....2



SJG\_M3X6.....1



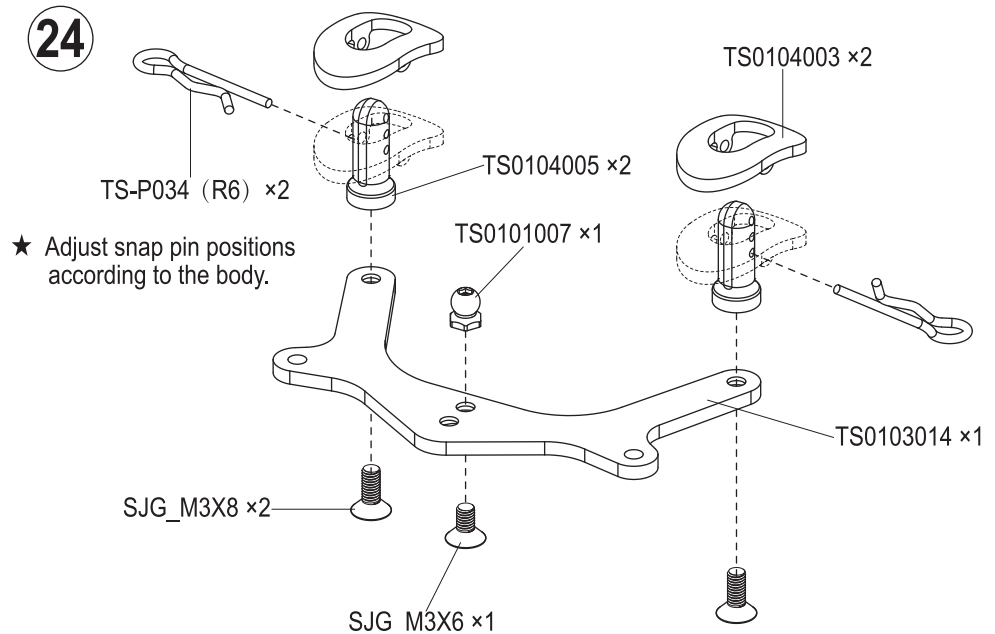

SJG\_M3X8.....2

## 24



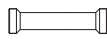





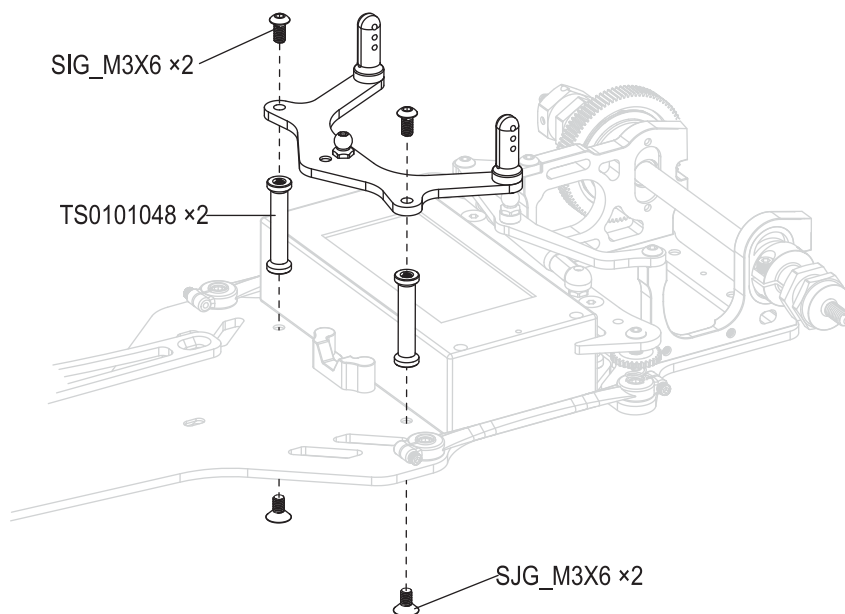

-  (L=26mm)  
 TS0101048.....2  
  
 SJG\_M3X6.....2  
  
 SIG\_M3X6.....2

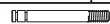
25



26 ~ 32  
Kit Bag H

-   
 TS0102009.....1  
  
 TS0104034.....1  
  
 TS0104037.....1  
 (Φ11.5×Φ14.5×Φ1.5)  
 TS0105002.....1  
 (Φ2.8×Φ6.6×Φ1.9)  
 TS0105004.....1  
  
 OE\_E2.0.....2

26

### Damper assembly

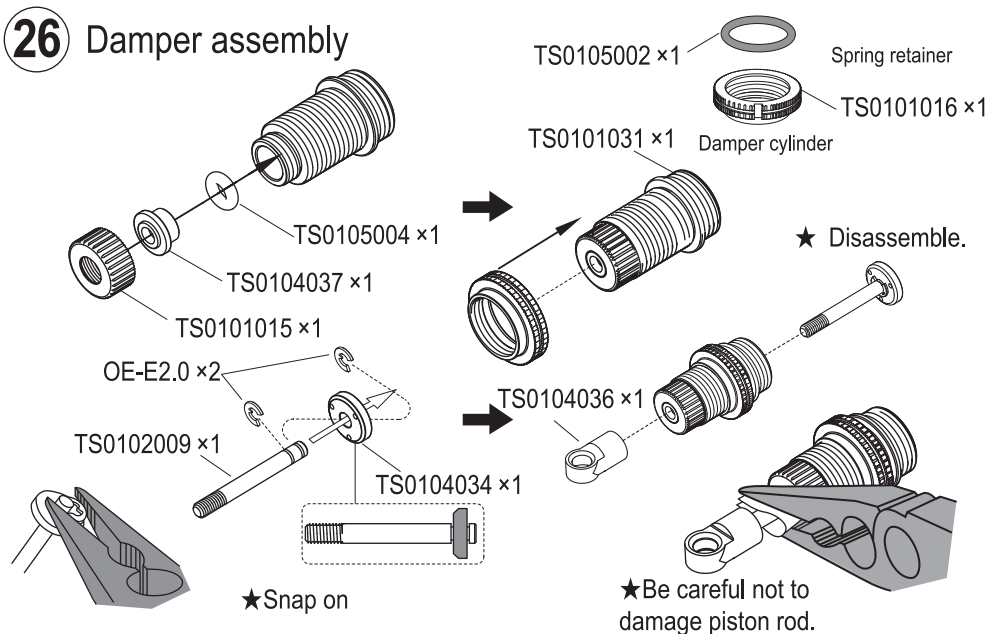

27

### Damper oil

1. Pull down piston and pour oil into cylinder. Remove air bubbles by slowly moving piston up and down.

2. Pull down piston, attach oil seal and absorb oil overflow with tissue paper.

3. Tighten cylinder cap.

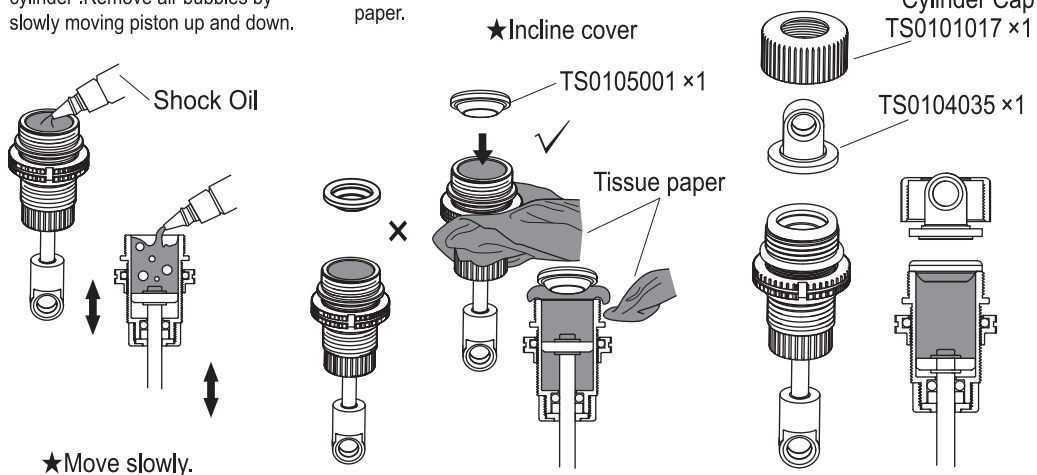

-   
 TS0105001.....1

VPPRO SHOCK OILS	
RS-304-150	150cSt
RS-304-200	200cSt
RS-304-250	250cSt
RS-304-300	300cSt
RS-304-350	350cSt
RS-304-400	400cSt
RS-304-450	450cSt
RS-304-500	500cSt
RS-304-550	550cSt
RS-304-600	600cSt
RS-304-650	650cSt
RS-304-700	700cSt
RS-304-750	750cSt
RS-304-800	800cSt



TS0102002.....1

## 28 Attaching dampers

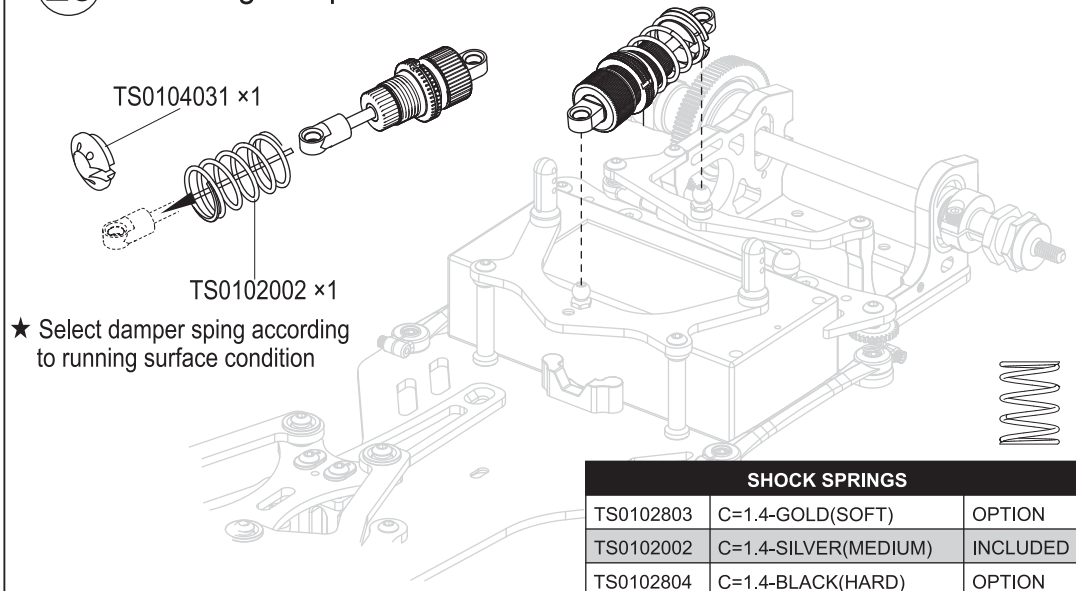

TS0101073.....2



TS0101007.....1



SIG\_M3X6.....1



SIG\_M3X8.....4



SIG\_M3X10.....1



TS0201032.....4

## 29 Alternative 1

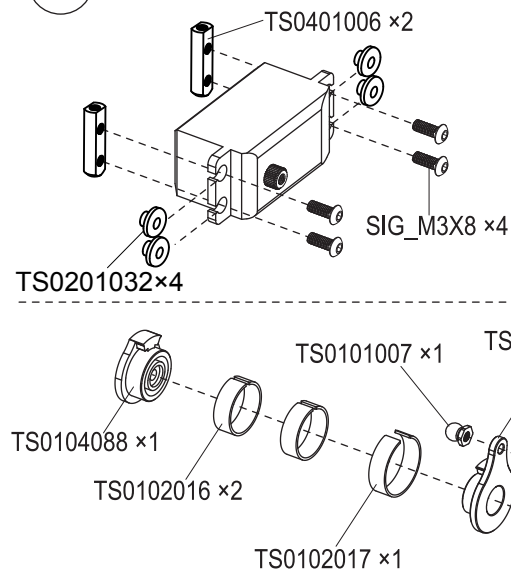

## Alternative 2

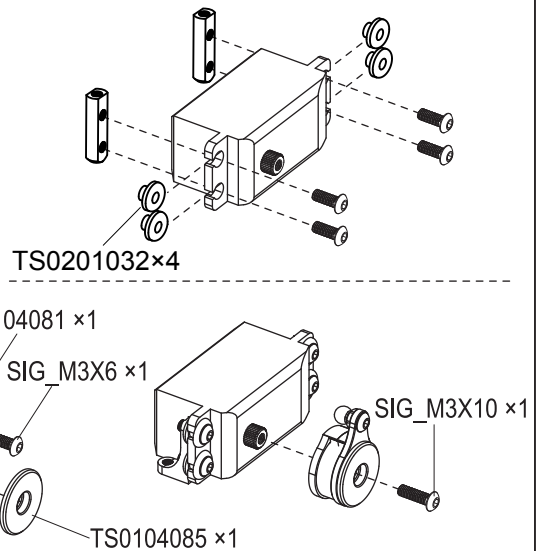

SJG\_M3X6.....2

## 30 Alternative 1

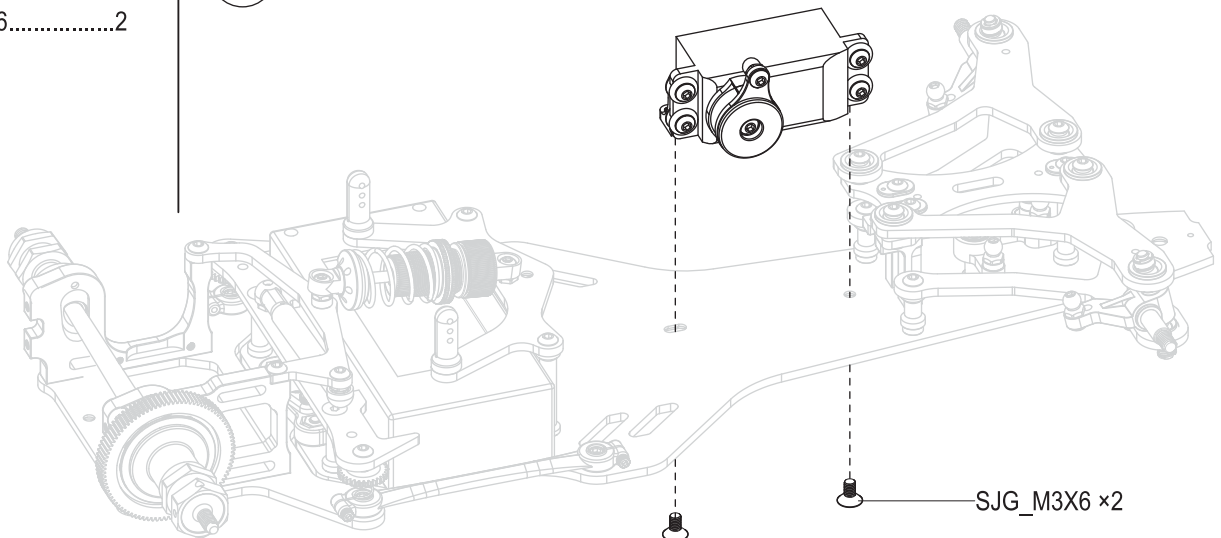

 SJK\_M3X6.....2

## Alternative 2

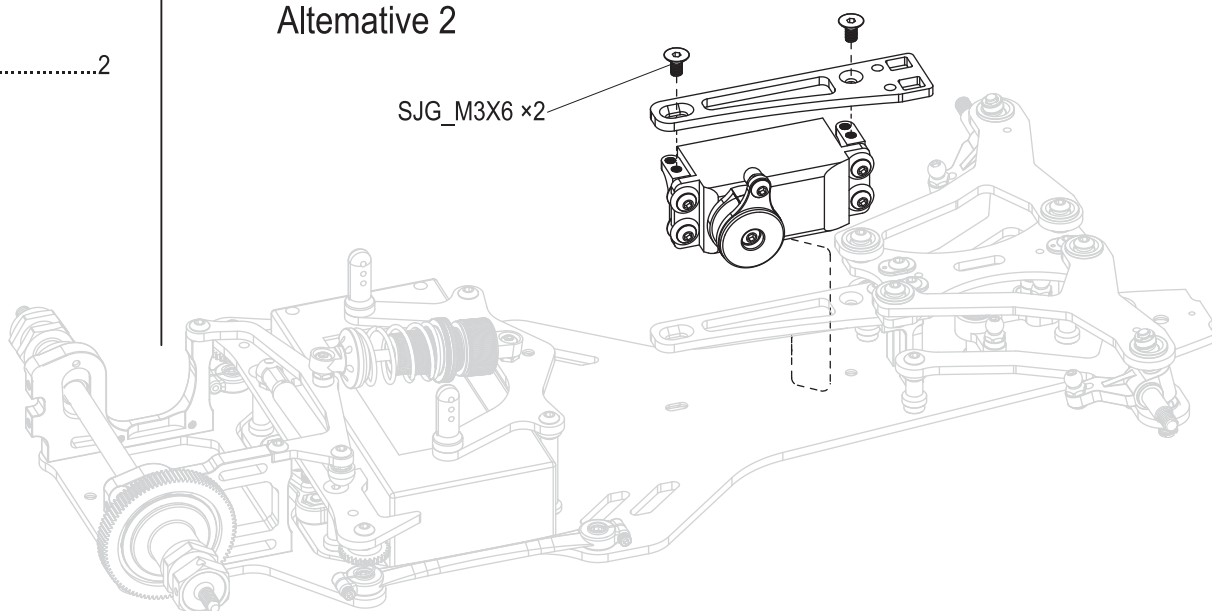





 SJK\_M3X6.....2

OP

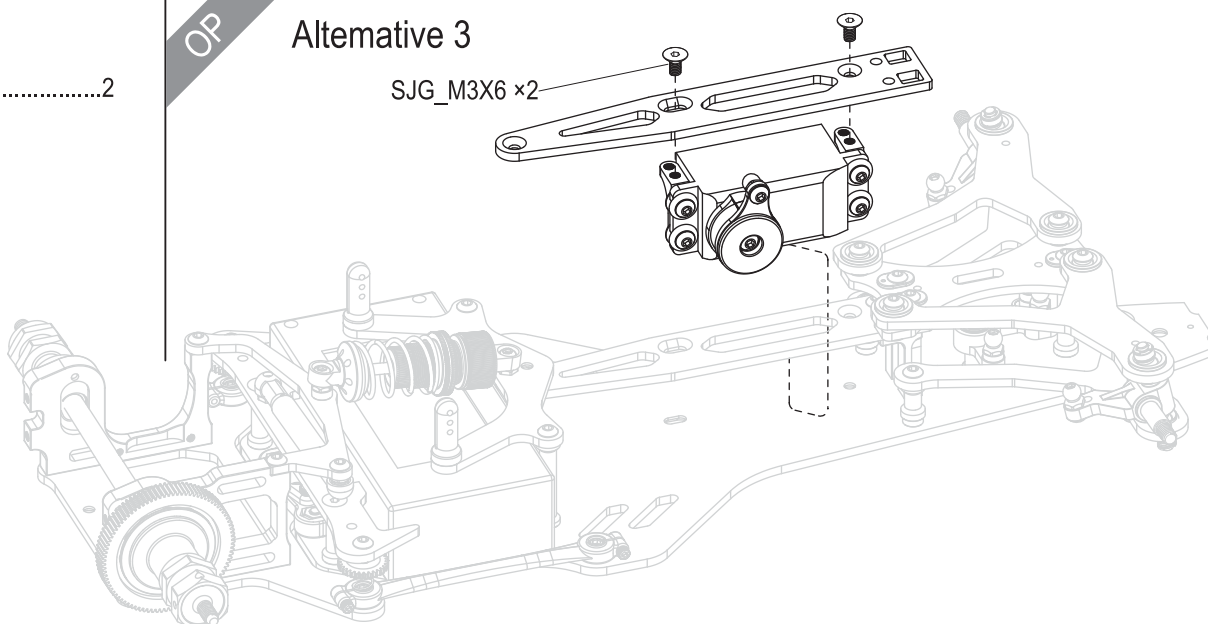
## Alternative 3

SJK\_M3X6 x2

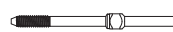

 (L=35mm )  
TS0102014.....2  
 (L=45.7mm)  
TS0102008.....1  
  
TS0104027.....6

## 31 Steering links

★ Adjust servo link to fit your servo

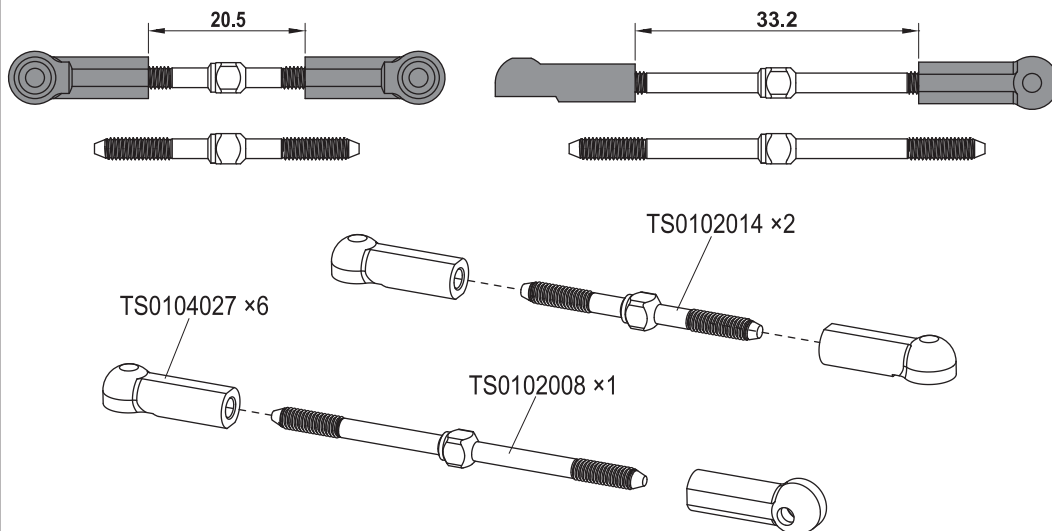

32

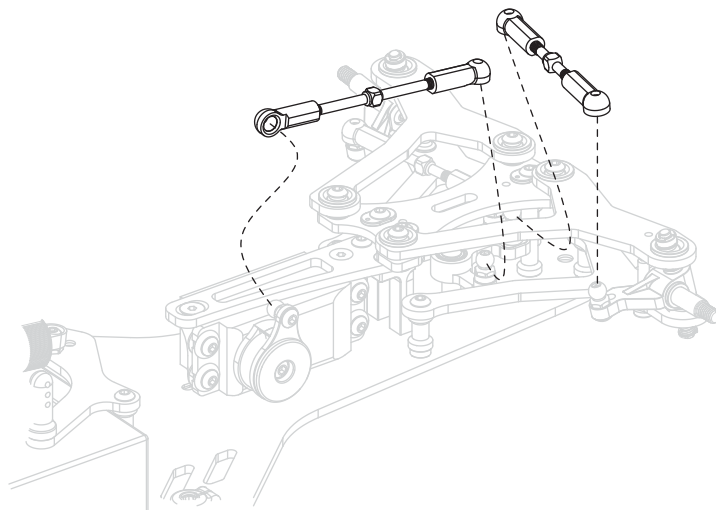

33 ~ 40  
Kit Bag I

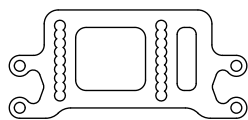

TS0103007.....1

◎ □ (H=6mm)

TS0101022.....2



SN\_M3.....2



SJG\_M2X6.....8



SIG\_M3X16.....2

33

Attaching rear wing

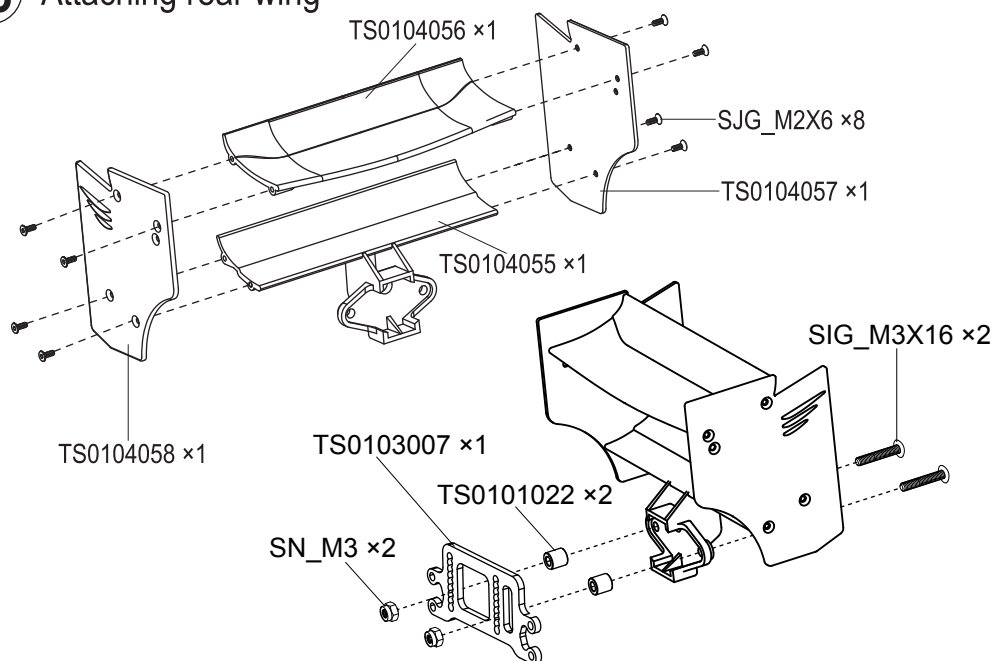

SIG\_M3X6.....4

34

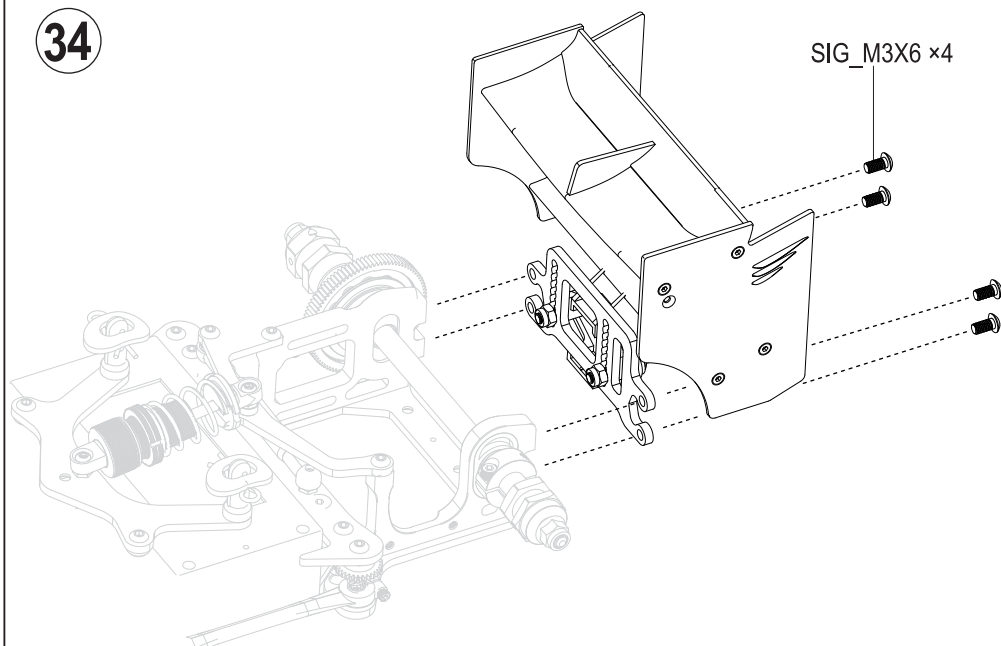



SJG\_M3X10.....2

### 35 Guide plate

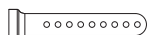
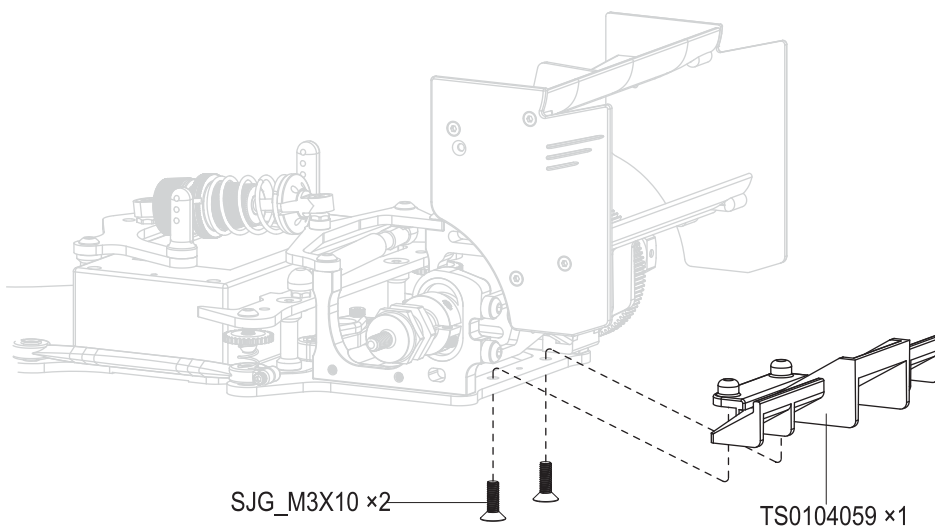

TS0104009.....1



TS0104003.....1



TS-P034 (R6) .....1



SIG\_M2X4 .....3



SIG\_M3X8 .....1

### 36 Attaching front wing

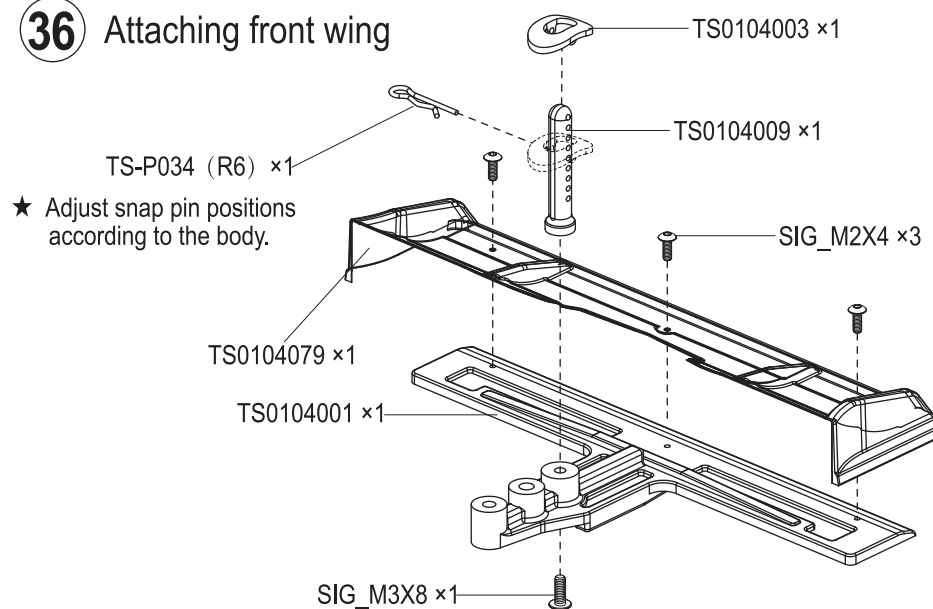

SJG\_M4X18.....2



SN\_M4 .....2

### 37

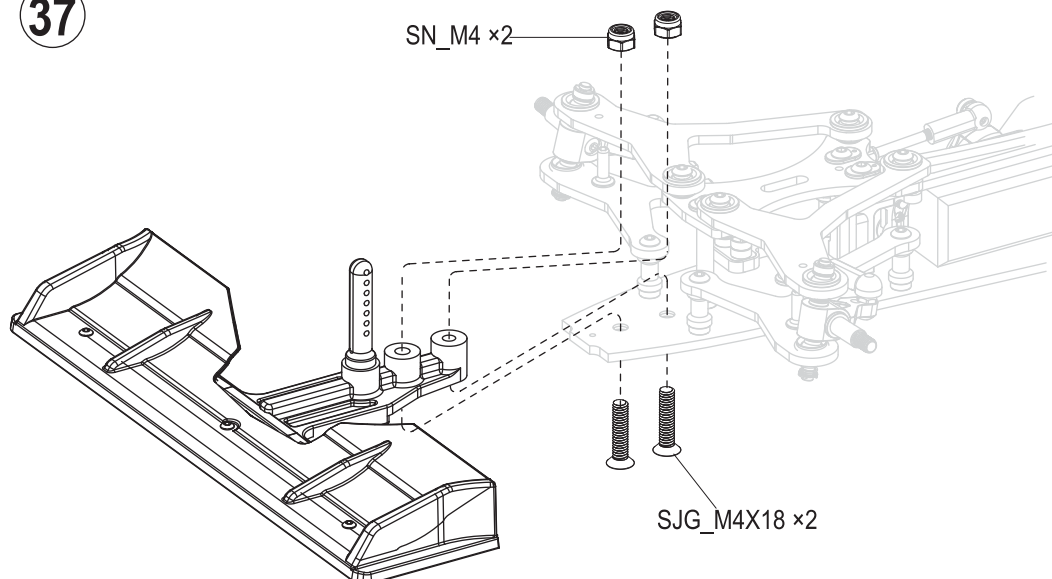





SJG\_M3X8.....2



SK\_M3X3.....1

38

SK\_M3X3 ×1  
SIG\_M3X8 ×2

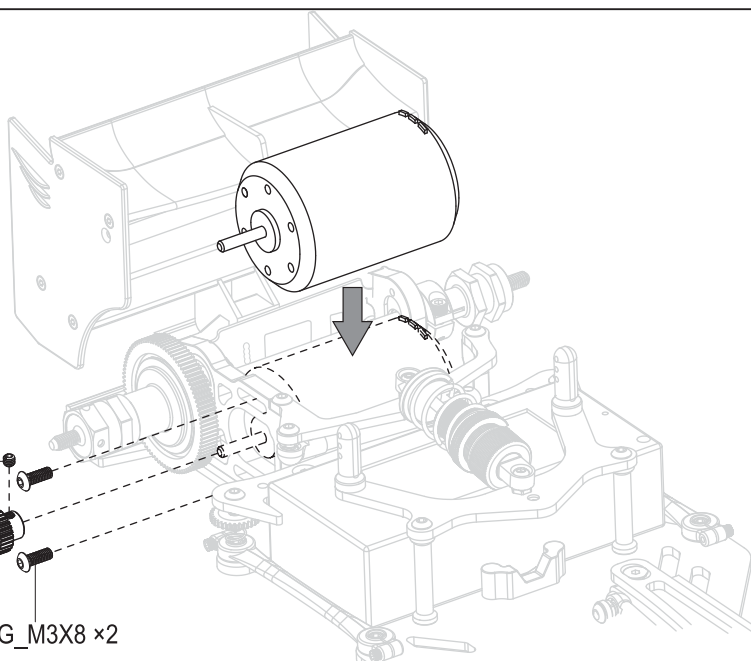

○ | (Φ5×Φ7×0.5)

TS0102018.....2

◎ (Φ5×Φ10×4)

MR105-OR.....4



SN\_M4.....2

39

Attaching wheels

★Tighten up into nylon portion.

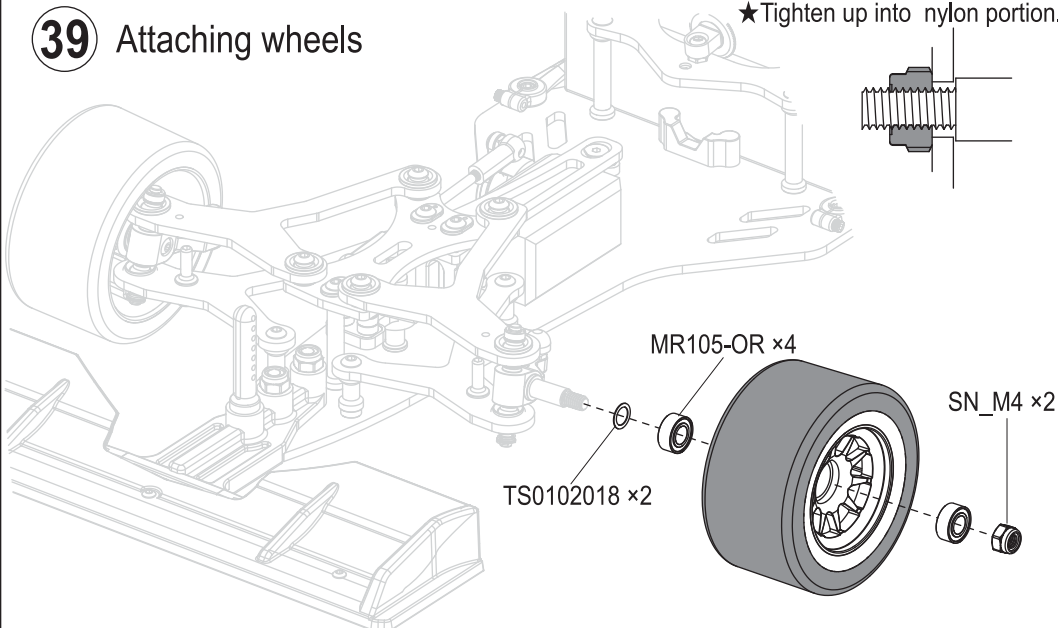

MR105-OR ×4

TS0102018 ×2

SN\_M4 ×2



SN\_M4-F.....2

40

★Tighten up into nylon portion.

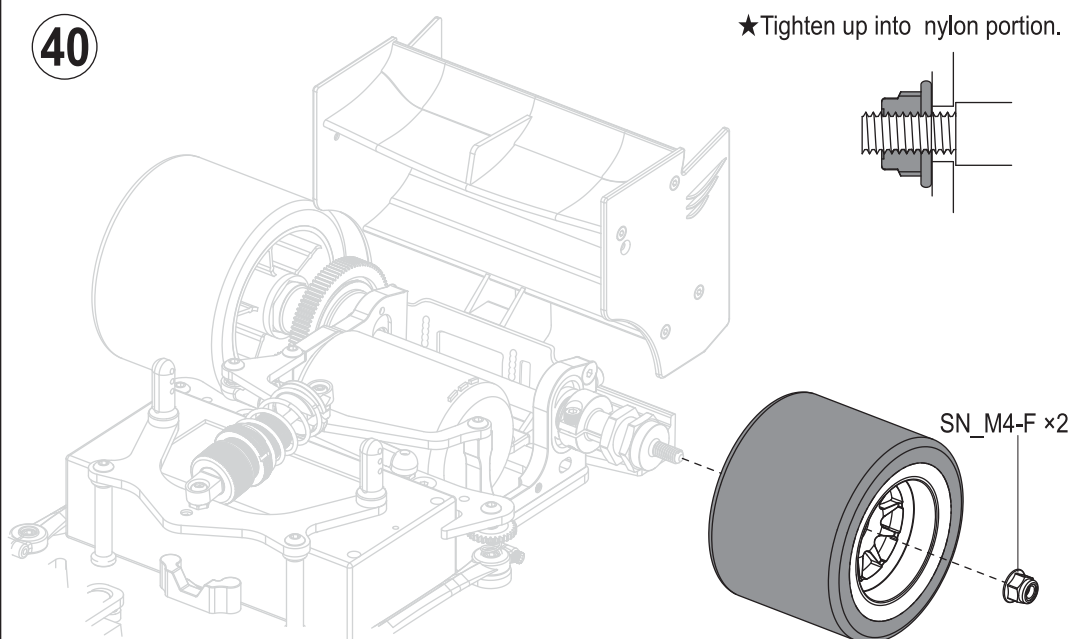

SN\_M4-F ×2

**NOTE:**



VA PON INDUSTRIAL CO.,LTD

<http://www.saxoracing.com>

E-mail:saxo@saxoracing.com

1F.NO.1,Ln,122,Chelutou St.Sanchong Dist,New Taipei City 241Taiwan 24157



TS0108029  
Ver 1.0

